



### Elegant Eye-Catcher

The **CONVIS 101** impresses with its clean, consistent and unique design. As the smallest monitor in the **CONVIS** series, this ultra-thin monitor is precision-crafted from a single block of aluminum. With a tempered glass front and flat back, it is just 8mm slim.

The crystal clear 10.1 inch monitor is mounted on a sturdy stand that allows a 30° tilt angle for ergonomic viewing.

Designed for situations where minimal dimensions and a low overall height are required. The monitor is extremely flexible in use - be it in meeting rooms, conference halls, entrance areas, sales rooms or plenary sessions. Just plug it in and start.

A successful combination of aesthetics and robustness. This is how the compact monitor presents itself for versatily used rooms.

Unique.  
Made in Germany.  
Made by **ELEMENT ONE**.

# CONVIS 101





## VERSATILE & FLEXIBLE

With the optional multipoint touchscreen CONVIS 101 becomes a real collaboration device. And available in many different anodized colors: CONVIS 101 matches your technological & optical demands.

- Ultra Thin BLADE Monitor Housing 8 mm
- 30° fixed Monitor inclination
- 2 mm Anti-reflective safety glass
- Compact Housing Dimensions
- Milled aluminum, black coated Monitor-Housing, steel
- *Optionally* with 20-points touchscreen\*
- Passive Cooling without Ventilation Openings
- HDMI HDCP compliant; WXGA native resolution
- EMC + EMV protected
- Maintenance free
- 5 years limited warranty

\* on demand, for an additional charge



## FEATURES

# CONVIS 101





## TECHNICAL DATA

# Product Specification



<b>Art.No.</b>	450-101	<b>Screen size:</b>	10.1" (16:9)
<b>Type</b>	CONVIS 101/30	<b>Resolution:</b>	1.200 x 800 - WXGA, 16.7M colors (6bits + Hi-FRC)
<b>Function</b>	Compact 10.1" conference & desktop monitor with fixed 30° monitor tilt angle. 8mm thin BLADE display with flat back.	<b>Brightness:</b>	300 cd/m2
<b>Material</b>	Monitor: Milled aluminum, powder coated RAL 9006 white aluminum metallic fine structure matt, 2 mm anti-reflective real glass pane Stand: Steel, powder coated; black RAL9011 fine structure matt; acrylic glass black, glossy	<b>Contrast:</b>	(typ.) 800:1
		<b>Viewing Angle:</b>	Horizontal 170 ° / vertical 170°
		<b>Response time:</b>	30ms (typ)
		<b>Viewing area:</b>	216.96(H) x 135.60(V)
		<b>Pixel pitch:</b>	0.0565 x RGB x 0.1695 mm
		<b>LED Life:</b>	up to 15,000 hours
		<b>Environment:</b>	0°-50°C
		<b>Mass:</b>	1.8 kg
		<b>Dimensions:</b>	242 x 152 x 156 mm (LxWxD)
		<b>Power Consumption:</b>	typ. 2.16 W. (OFF: 0.12 Watt, Sleep: 0.60 ON: 2.16 W)
		<b>Inclination Angle:</b>	fix 30°
		<b>Video Interface:</b>	HDMI, Displayport
		<b>Touchscreen (Option):</b>	USB
		<b>Warranty:</b>	5 years (limited, see warranty specification)
		<b>Scope of supply:</b>	Desktop power supply - Input: 100-240V~, 50/60Hz. 1.5A; Output: 12V 5A 60W MAX (Cable length DC ~140cm) IEC cable 1.5m / HDMI connection cable 2 m

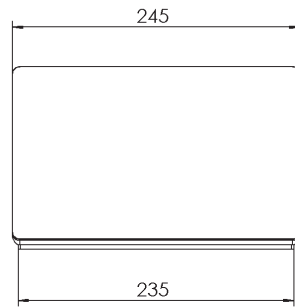

118

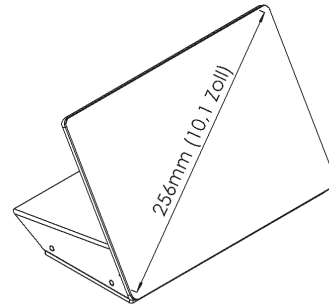
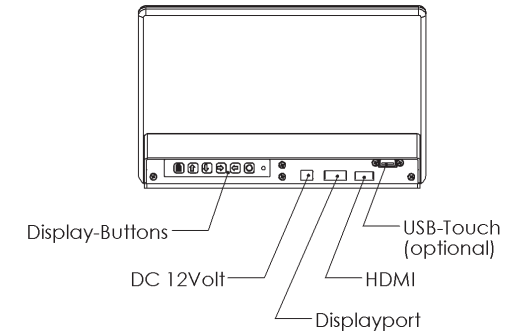
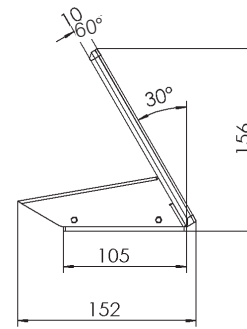

# Dimensions



We'd be delighted to offer our expertise in the planning and selection of the right solution for your needs. If required, we can send further technical drawings, detailed photographs, material samples and, of course, demo devices – perfect to handle and try out.

**Simply call us on +49 (0)7222 96654-20**

**Or send us an e-mail at: [info@element-one.de](mailto:info@element-one.de)**

**ELEMENT ONE**

**Multimedia GmbH**

Zum Murgdamm 5

76456 Kuppenheim

Germany

Fon: +49 (0) 7222 966 54 20

Mail: [info@element-one.de](mailto:info@element-one.de)

[www.element-one.de](http://www.element-one.de)